

Window Bolt Locks

RETROFITTED WINDOW SECURITY

The Lock Focus Window Bolt and Mini Window Bolt provide retrovittable, versatile security. With a snap to position bolt and keyed deadlocking, these compact designs suit a large range of configurations and window types.

FEATURES

- Keyed locking barrel for added security
- Sleek design styled to sit neatly on window frame
- Ergonomic bolt grip for easy operation
- Reversible design allowing for left or right hand installation
- Available in a variety of colours

MATERIALS

- Main body constructed from diecast zinc
- 10mm diecast security bolt, tested to withstand up to 800kg of force

APPLICATION

- For aluminium and timber windows
- Suitable for sliding, awning, casement and double-hung window types

KEYING

- Wafer cylinder key numbers available
- C4 keying available upon request
- Compatible with Lock Focus **One Key Solution**



LOCKFOCUS

FREE PHONE: 1800 687 116
Email: sales@lockfocus.com.au

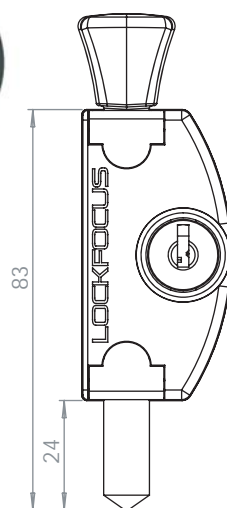

WINDOW BOLT

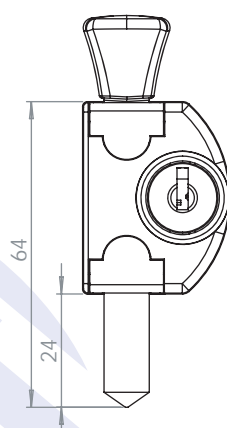
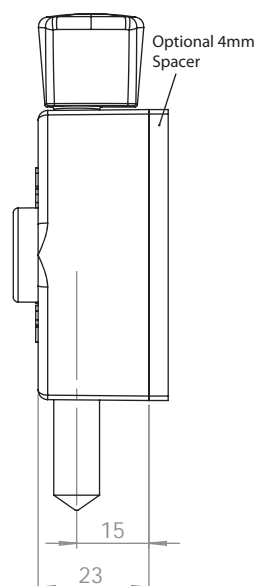

MINI WINDOW BOLT

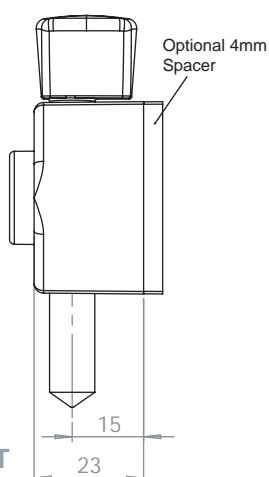

LOCK FOCUS WINDOW BOLT

Keyed security bolt lock for use with sliding, double hung, awning, and casement aluminium or timber windows. Snap to position bolt with keyed barrel for deadlocking.

Speak with your local locksmith prior to installation about the LOCK FOCUS *One Key Solution* for your home.

Required Tools

- Drill
- 3mm & 12mm drill bits
- Phillips head screw driver
- Centre punch / nail
- Pencil & ruler / measuring tape

Components

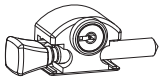

Window Bolt Body
incl. 1 barrel with key
(mini version shown here)



End Caps

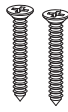

Wood
Fixing Screws



Aluminium
Fixing Screws



Ferrules



Ferrule
Screws

Fixing Locations

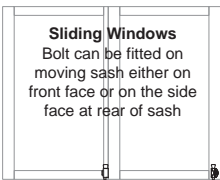

Sliding Windows
Bolt can be fitted on moving sash either on front face or on the side face at rear of sash

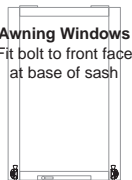

Awning Windows
Fit bolt to front face at base of sash

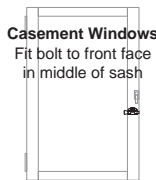

Casement Windows
Fit bolt to front face in middle of sash

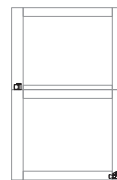

Double Hung Windows
Fit bolt to moving sash on front face of lower sill, OR if both windows slide, fit to lower window on top face of upper sill and lock into top window

Instructions

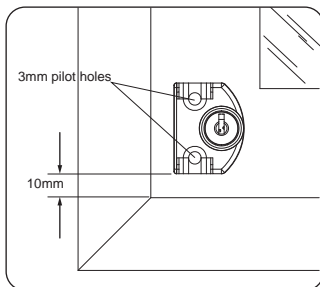

1. Mark fixing screw locations

Hold *Window Bolt* body in desired orientation (at least 10mm clearance from the bottom of the frame) and mark centre of screw holes. Drill two 3mm pilot holes to suit fixing screws

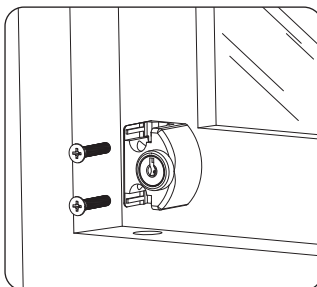

2. Attach lock to frame

Screw lock body into position using appropriate screws for frame material

(Note: screws for timber have a sharp point, screws for aluminium have a twisted end)

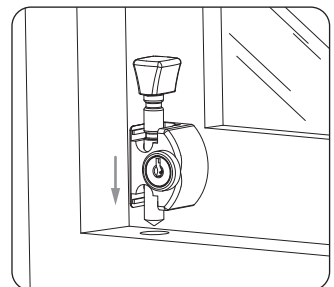

3. Location of Ferrule

Ensure window is fully closed. Insert bolt into body and use end of bolt to mark drill location. Drill 3mm pilot hole. Drill 12mm bolt hole, ensure hole is deep enough for full movement of bolt

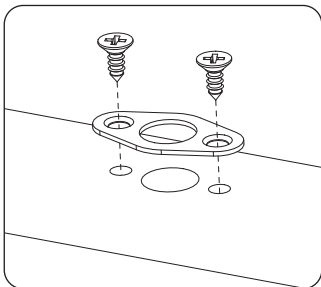

4. Fit Ferrule (for timber applications)

With ferrule held in position, mark centre of fixing holes. Drill 3mm pilot hole to suit fixing screws. Fix ferrule into position. For a fixed ventilation position on sliding and double hung windows, repeat process using second ferrule 100mm along the frame

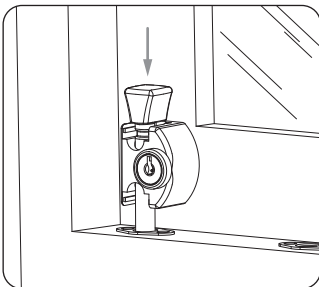

5. Check operation

Insert bolt into body and ensure bolt engages fully in frame so that key can be locked

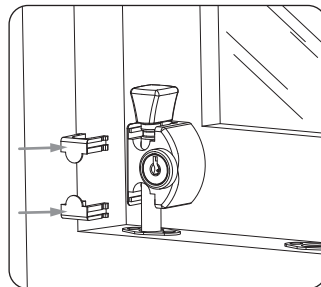

6. Clip in end caps

When satisfied with operation, slide bolt into locked position and clip in the two end caps provided (tap gently with a hammer if unable to push in by hand)

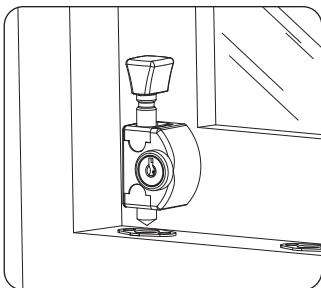

7. Operate window

Return bolt to unlocked position and operate window to ensure bolt is clear of any obstacles

Optional Mounting Spacer

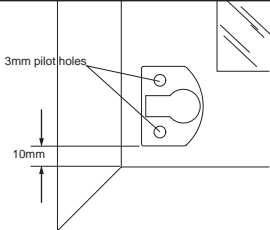

For optimum clearance of locking hole position, a mounting spacer may be required on some windows.

To install spacer, hold in desired orientation (at least 10mm clearance from the bottom of the frame) and mark centre of screw holes. Drill two 3mm pilot holes to suit fixing screws.

Place lock body over spacer and follow instructions outlined above, starting from Step 2