

2-POINT LOCK

Applications

This lock is ideal for hinged/sliding/tambour door applications and allows for 2-point locking on timber or metal cabinets.

Specifications

- Zinc alloy diecast housing
- Glass-reinforced nylon backplate
- Key removable in locked or unlocked positions
- 90° anti-clockwise key rotation to unlock



A/2PL

Code Information

Dimensions/Fixing shown NTS

KEY SERIES

- 01 200 combinations - non-mastered
- 02 200 combinations - mastered
- 07 500 combinations - non-master keying
- 08 500 combinations - master keying
- 17 2000 combinations - non-master keying
- 18 2000 combinations - master-keying

Also available in Barrel Exchange

Note: 1200 x 8 x 3 aluminium locking bar and saddles are available. See Applications section H, page H3.

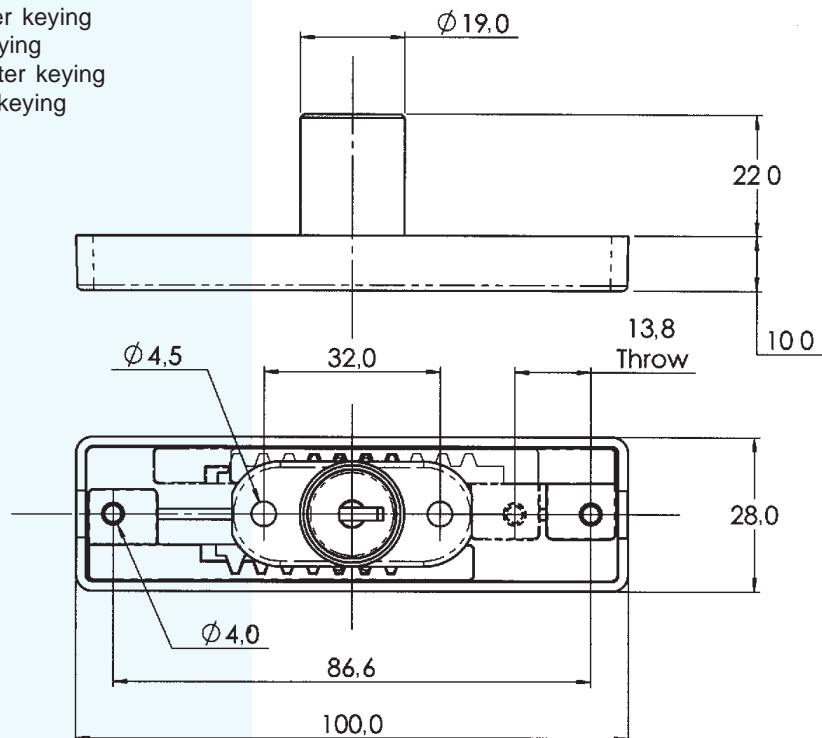

Ordering Details

Measurements shown in mm

STEP 1 STEP 2 STEP 3

A / 2 P L - / KEY SERIES / 3 C

Ordering example: A / 2 P L - / 0 1 / 3 C / - - -

- ADVISE Keying requirements, e.g. keyed alike

2-POINT LOCK

The 2-point lock is available with 1.2 m aluminium locking bars and saddles.

Refer to pages **A32** and **C10** for further product details.



A/2PL-/R2/3C/K03



SADDLE
M/2PLS/6

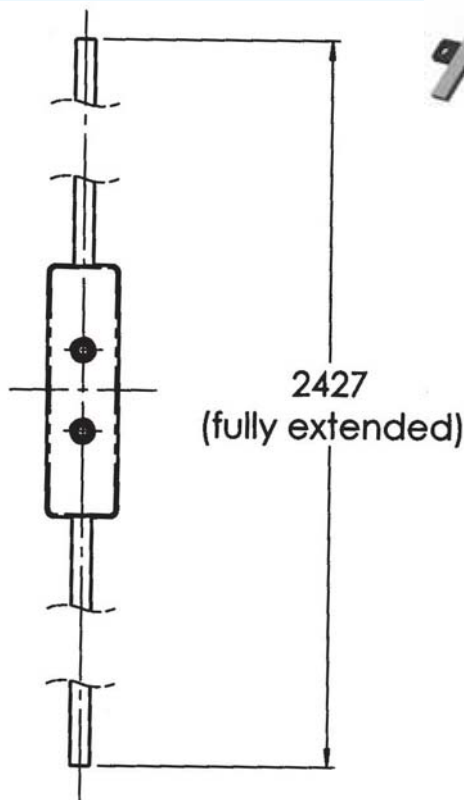

2427
(fully extended)

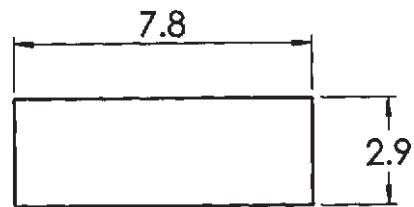

Locking bar profile

P/AL2P/12