

# SPANNER LOCK 18 MM - IP65 RATED

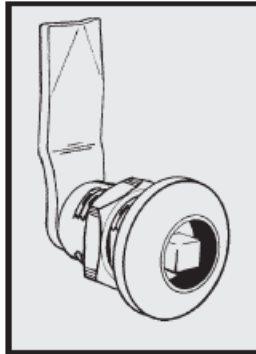

## Dimensions

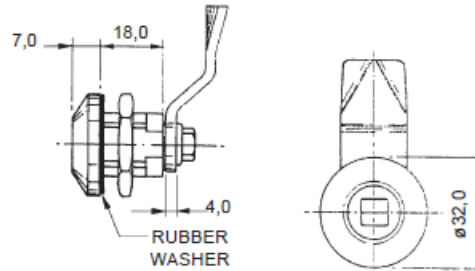

## Barrel Inserts

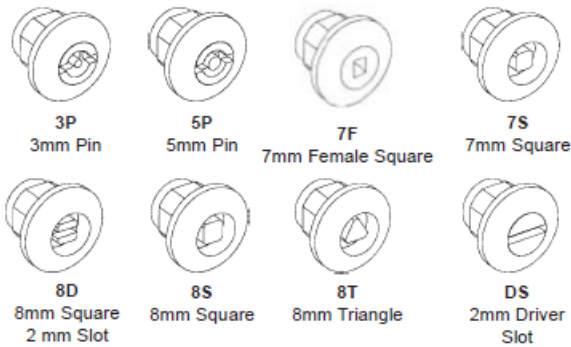

## Fixing Hole Details

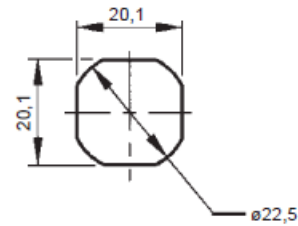

## Ordering Details

	1	2	3	4	5	6	7	8	9	10	11	12	
ASSEMBLY	A												
MODEL	S	R	1	8									
BARREL INSERT					*	*							SEE ABOVE
FINISH							3						BRIGHT CHROME
MOVEMENT								S					90 DEGREES CLOCKWISE TO UNLOCK
								A					90 DEGREES ANTI-CLOCKWISE TO UNLOCK
FIXING										H			NUT
CAM TYPE											*	*	REFER CAM DATA SHEET PAGE
EXAMPLE:	A	S	R	1	8	7	S	3	S	H	S	1	

NOTE: SPECIFICATIONS SUBJECT TO CHANGE WITHOUT PRIOR NOTICE

MARCH 2003